

User Manual

STEAM OVEN

Thank you for your wise decision to purchase our steam oven. Please carefully READ these instructions BEFORE INSTALLING AND USING the appliance and retain them for future reference. Keep potentially hazardous packaging (plastic bags, polystyrene, etc) out of reach of children.

Contents

Safety Instructions	1
Description of the Appliance	2
Installation Instructions	3
Electrical schematic diagram	6
How to Use Your Oven	7
Cleaning and Maintenance	8
Replacing the oven lamp	8

Safety Instructions

※ **Warning: Only a qualified person can install, repair and remove the oven. Please keep child away.**

Before you use the steam oven for the first time, turn the appliance on at highest temperature. This will remove oils left on the appliance during manufacture.

- Do not leave cooked food in steam oven for a long time to avoid too much condensation generated on door.

- Do not unplug the socket with wet hands.
- Never cover the vents provided during heating.
- Please unplug the socket, wait the steam oven to cool down before cleaning for your safety.

- When cooking is finished, please keep a distance from oven door as there will be much hot steam.

- After cooking we recommend that you should clean food left in the steam oven and condensation produced on the inner glass of the steam oven immediately.

- After cooking, extra water would be back to water tank. Please empty the water tank.

- Never use the steam oven for heating installation.

- Calling the qualified staff to repair if the appliance does not work normally.

- Do not use harsh abrasive cleaners or sharp metal scrapers to clean the oven door glass since they can scratch the surface, which may result in shattering of the glass.

- In order to ensure the food is delicious, we recommend that pour into fresh water before cooking.

- This appliance is not intended for use by persons (including children) with reduced physical sensory or mental capabilities, or lack of experience and knowledge, unless they have been given supervision or instruction concerning use of the appliance by a person responsible for their safety.

- This appliance is for household use and complies with the EEC directives currently in force. The appliance is for cooking and heating food.

※ **Dealers and users for failure to comply with the above instructions replace steam oven parts and not use original accessories caused personal injury and property damage, the company will not be responsible for any legal liability.**

- The instructions state that:

- - the appliance is not to be used by persons (including children) with reduced physical, sensory or mental capabilities, or lack of experience and knowledge, unless they have been given supervision or instruction

- - children being supervised not to play with the appliance

- Instructions shall include the following:

- Warning: If the surface is cracked, switch off the appliance to avoid the possibility of electric shock, for hob surfaces of glass ceramic or similar material which protect live parts. During use the appliances becomes hot. Care should be taken to avoid touching heating elements inside the oven, for cooking ranges and ovens

- Instructions for ovens:

- Warning: Accessible parts may become hot during use. Young children should be kept away.

- Instructions for ovens having doors with glass panels:

- Do not use harsh abrasive cleaners or sharp metal scrapers to clean the oven door glass since they can scratch the surface, which may result in shattering of the glass.

- Instructions for cooking ranges, hobs and oven

- -shall state a steam cleaner is not be used

- -Warning - Ensure that the appliance is switched off before replacing the lamp to avoid the possibility of electric shock .

- The instructions for ovens that have shelves shall include details indicating the correct installation of the shelves

- If the supply cord is damaged, it must be replaced by the manufacturer, its service agent or similarly qualified persons in order to avoid a hazard.

Description of the Appliance

- Our products are produced by environmental protection packaging materials, so you in dealing with these packing materials should pay attention to packaging material recycle utilization, protection and preservation of our environment. Don't discarded plastic packaging to prevent children playing in the danger caused by asphyxia.

- Please send your rejected productions to Environmental Conservation Organization or authorized Electrical recycle bin, this will recycle useful materials and reduce the hazards of environment.

AVAILABLE ACCESSORIES

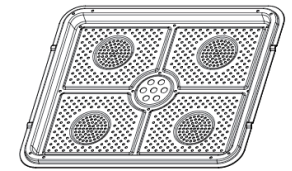

PERFORATED PAN

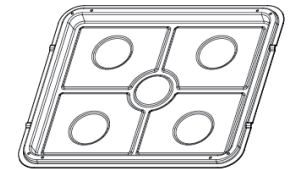

NON-PERFORATED PAN

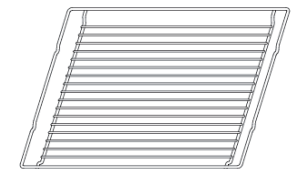

RACK

TECHNICAL SPECIFICATION

PRODUCT	STEAM OVEN
MODEL	ZA5665 / ZA5668 / 620D / 620L
VOLTAGE (V)	220V~
FREQUENCY (Hz)	50
POWER(STEAM)(W)	2300
CAPACITY (L)	45
N.W.(KG)	29
G.W.(KG)	31.8
DISPLAY MODE	LED DIGITAL PLAY
PRODUCT SIZE (mm)	455×595×520

STRUCTURE OF DIAGRAM

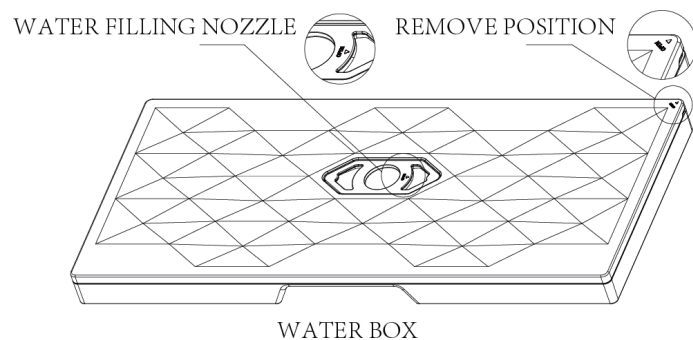
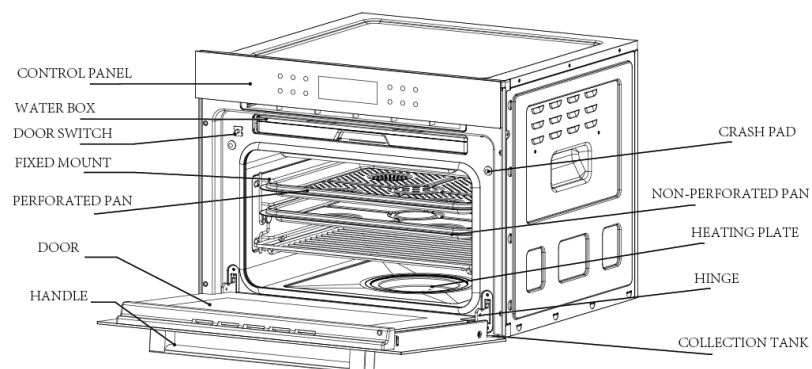

Installation Instructions

- Only a qualified person in compliance with the instructions provided must install the appliance. The manufacturer declines all responsibility for improper installation, which may harm persons and animals and damage property.
- Important: - The power supply to the appliance must be cut off before any adjustments or maintenance work is done on it;

- Air duct is supposed to use in Ventilation.
- If we put the steam oven into cabinet, the cabinet material should be insulated, and the clearance between the edge of the cabinet and the oven should be over 500mm for ventilation.

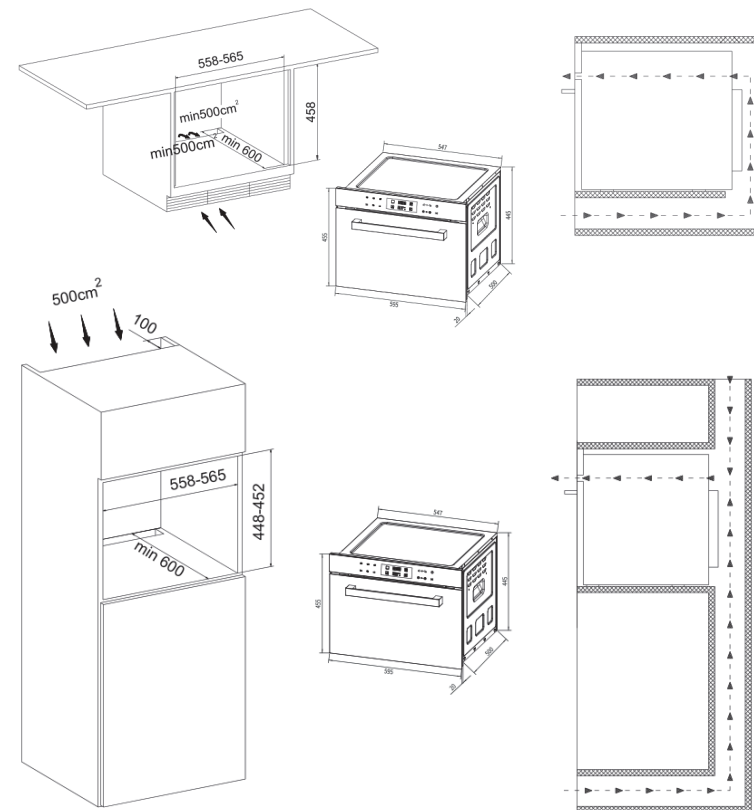

- In order to fix the steam oven with cabinet, please open the steam oven door and insert four wood screws into the four hole around frame and fix them.

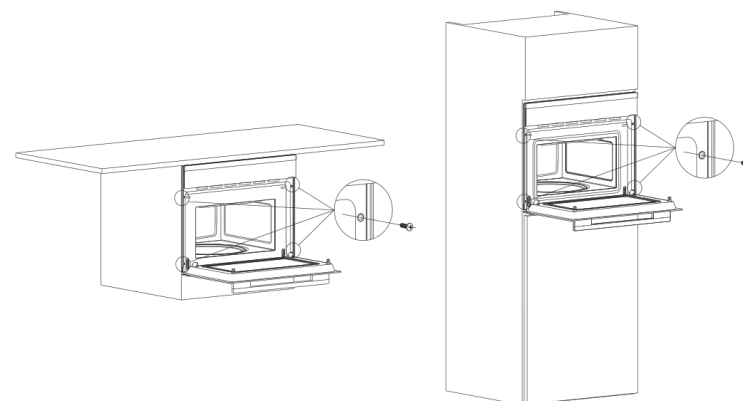



Take the installation of the left fixed frame as an example:
First, the front and rear two openings of the fixed frame are aligned to the position of the fixed shaft of the whole machine, touching the inner wall of the cooking box and advancing from behind.
Then, when the position of the two bayonet can not move forward, the front side will be pressed downward until it does not move.

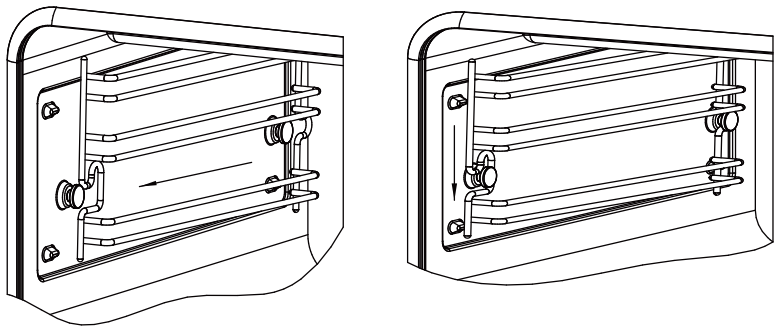

Disassembly method:
First, lift the front side of the fixed frame smoothly to ensure that the front fixed axis is located outside the slot.
Then, remove the retaining frame along the inner wall.

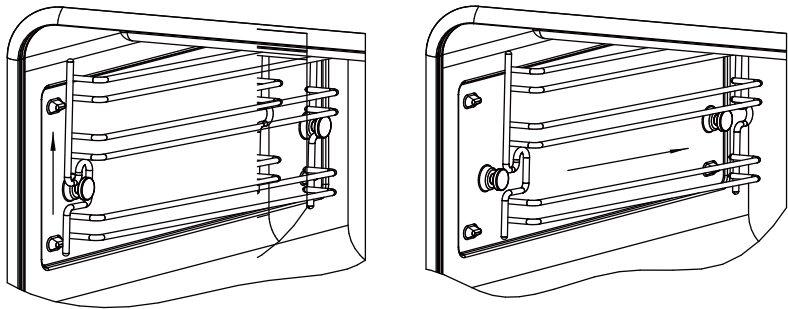

- Note: the installation and handling, please do not use the handle for stress point

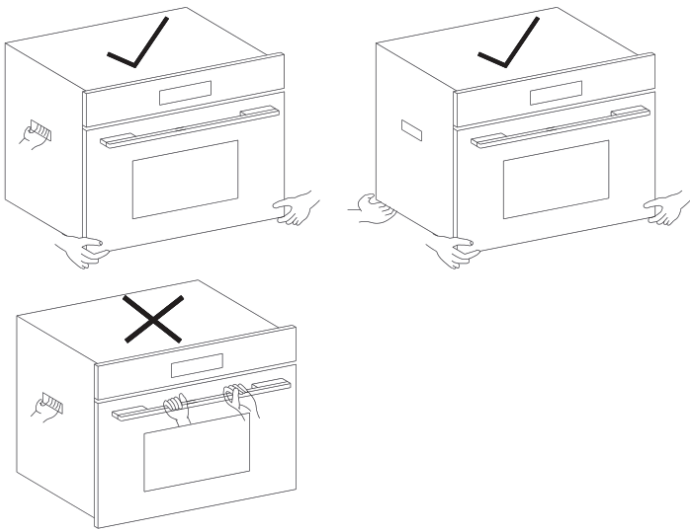

Electrical schematic diagram

Product Name	Steam Oven	Model No.	
Rated Pressure	220~240V~	Rated Frequency	50-60Hz
Rated Power	2400W	Capacity	45L
Electric Shock Resistance	I	Production Date	
Manufacturer	HANGZHOU DE&E APPLIANCES CO., LTD		

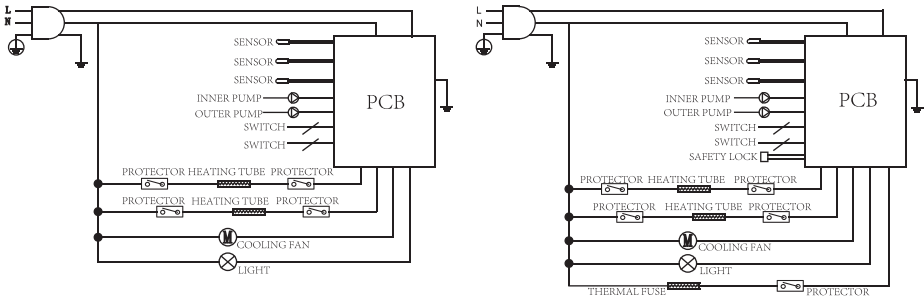

Installation Instructions

DESCRIPTION OF FRONT PANEL CONTROLS

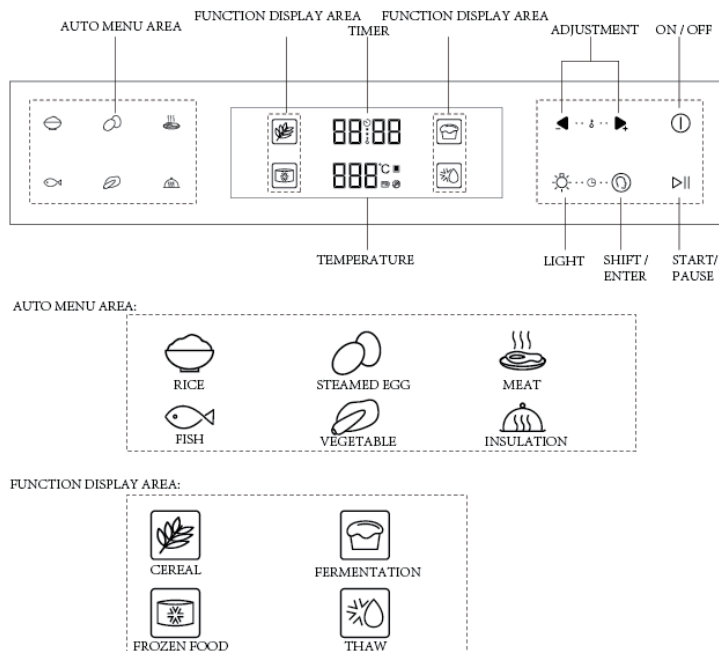

USING THE OVEN

• Clock Setting

When the first use, press the button “ⓘ” for 3 seconds and the display screen shows a flashing “0:00”; Press the button “◀” or “▶” to increase or decrease the hours; After setting hours, press “Ⓢ” to set the minutes. Press “◀” or “▶” to increase or decrease the minutes and press “Ⓢ” to confirm the current time. Press for 3 seconds if you want to setting time again. Clock set range: 0:00 - 23:59.

• Child Lock

Lock: In waiting state, press “◀” or “▶” for 3 seconds, there will be a long beep, denoting entering into the children-lock state and “Ⓢ” indicator will light. No matter in any case after lock, screen will always display block for 3 seconds, and then return to the previous interface.

Unlock: Pressing “◀” or “▶” for 3 seconds in the state of lock, you will hear “beep”. Screen shows the current time and the symbol “Ⓢ” light go out.

• Steam Functions

In standby state, press the “◀” or “▶” for 1 second and it will enter the function menu selection mode, on the screen will show the default cooking time and the corresponding temperature. If you don't want to change any cooking time or temperature, just press the button “▶||”.

Press “Ⓢ”, the operating parameters (time, temperature, function) can be modified, use “◀” or “▶” to set desired time and temperature. Press “▶||” to continue cooking.

• Auto Menu Area

Six screen shortcut menus, rice, steamed egg, meat, fish, vegetable and insulation has been specially prepared for customers. Choose one of the menu and press “▶||” button to start cooking.

• Descaling

It's time to operate descaling mode when the oven shows “☼” on screen, press “▶” and “Ⓢ” to start descaling.

Add 0.4L water with 20g lemon cleaner to water box .

In standby mode, press “◀” and “▶” at the same time, and then press “Ⓢ” to start descaling mode.

When you hear the sound “D” for 3 times, open the door and take out the water box, pour away the descaling water and inject clean water. And then press “▶||” to continue descaling.

When you hear the sound “D” for 5 times, the descaling mode is done.

Cleaning and Maintenance

※ **Before cleaning your oven or performing maintenance, please cut off the power supply. In order to prolong the service life of steam oven, please note the following points:**

- The enameled or stainless steel parts should be washed with lukewarm water without using any abrasive powders or corrosive substances which could ruin them ;Stainless steel could get stained .If these stains are difficult to remove, use special products available on the market. After cleaning, it is advisable to rinse thoroughly and dry.
- The inside of the oven should preferably be cleaned immediately after use, when it is still warm, with hot water and soap; the soap should be rinsed away and the interior dried thoroughly. Avoid using abrasive detergents

(for example cleaning powders, etc) and abrasive sponges for dishes or acids (such as lime scale -remover, etc.,) as these could damage the enamel .If the grease spots and dirt are particularly tough to remove, use a special product for oven cleaning, following the instructions provided on the packet. Never use a steam cleaner for cleaning inside of oven.

- Suitable for descaling of cleaner, such as liquid coffee machine descaling cleaner. Share not with foam cleaner.
- Avoid using grinding sand mold cleaner, such as wash mat, steel wire ball, etc, may damage the surface.
- Important: please don't water tank in the dishwasher cleaning.

Replacing the oven lamp

- Disconnect the oven from the power supply by means of the Omni polar switch used to connect the appliance to the electrical mains ;or unplug the appliance if the plug is accessible ;
- Remove the glass cover of the lamp-holder ;

- Remove the lamp and replace with a same type lamp.
- Replace the glass cover and reconnect the oven.