

USER INSTRUCTIONS

GENERAL

ATTENTION

Thank you for purchasing this product.

Please read the following important information regarding installation safety, operating the product and maintenance instructions. Keep this information booklet accessible for further consultations. The appliance has been designed for use in a ducting version (air exhaust to the outside) and a recommended 2 – 4 burner cooker hob.

To avoid unexpected drop of range hood, pls drive a M4*16 screw through the center round hole on the hanger.

If you find any abnormality with the product, please contact the retailer or agent you've purchased from.

We would like to advice that all installation and after sales service repairs should be carried out by certified electricians or our authorised contractors.

CONTENTS

PAGE NUMBER

Accessories & Packing List	1
Parts Name Diagram	1
Electrical Circuit Diagram	1
Main Technical Parameter	2
Installation Diagram.....	2
Installation Steps.....	3
Safety Instructions.....	5
Opreating Instructions.....	5
Detachable Parts.....	6
Troubleshooting.....	7

Accessories & Packing List

1. Range Hood x 1 unit
2. User Instructions manual x 1 pc
3. Flow Exit x 1 pc
4. Flow Exit seal x 1 pc
5. Oil clection container x 1 pc
6. Flexible exhaust duct x 1 pc

Parts Name Diagram

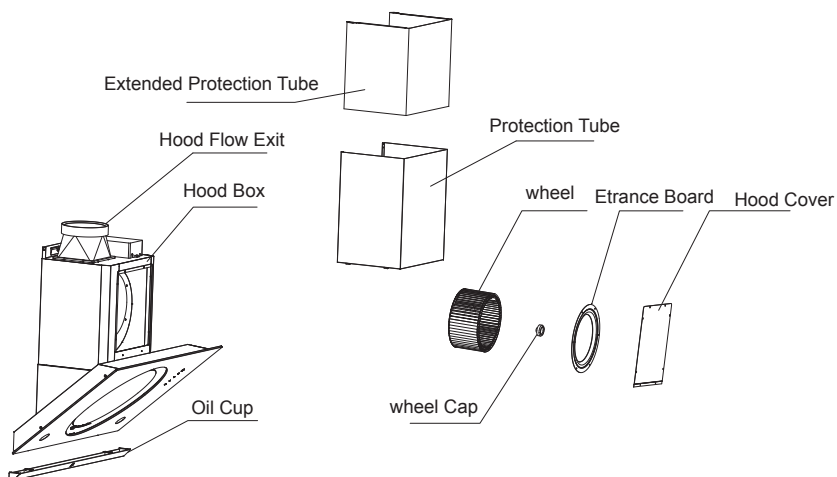

Electrical Circuit Diagram

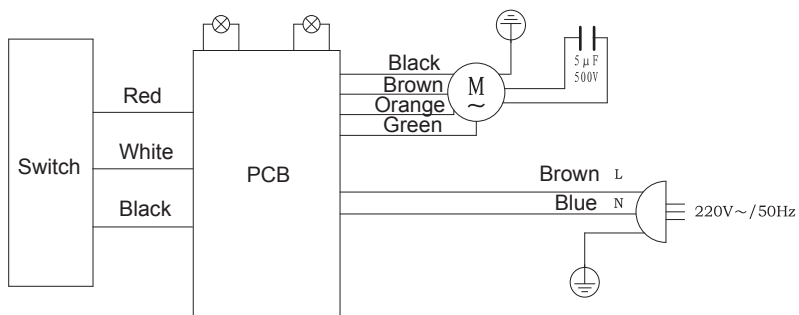

Main Technical Parameter

Model No	HA9055	HA9053	HA9052
Rated Voltage	220V~		
Rated Power	50Hz		
Max Airflow	19m³/min)		
Max Noise Level	54dB		
Max Pressure	≥390Pa		
Wind pressure	≥300Pa		
Lighting	≤4W		
Motor Capacity	230W		
Tot.Absorption	234W		
Product Size	895X506X920(mm)		
N.G	31kg	30kg	32kg

installation diagram

IMPORTANT: Installation must be carried out by our registered contractors.

1) Installation Height

Minimum height from the hob surface to the underside of range hood:

- 350 mm for electric hob
- 400 mm for gas hob

*If the instruction for the gas hob installation specified a greater distance, this has to be taken into account

NOTE: Any installation above 700mm will compromise the performance of this range hood.

If the ceiling is low and hood is installed without extended chimney, there should be at least 3cm gap between the ceiling and chimney.

2) Exhaust Duct

The length of the exhaust duct should be minimised to avoid air trubulence inside the duct

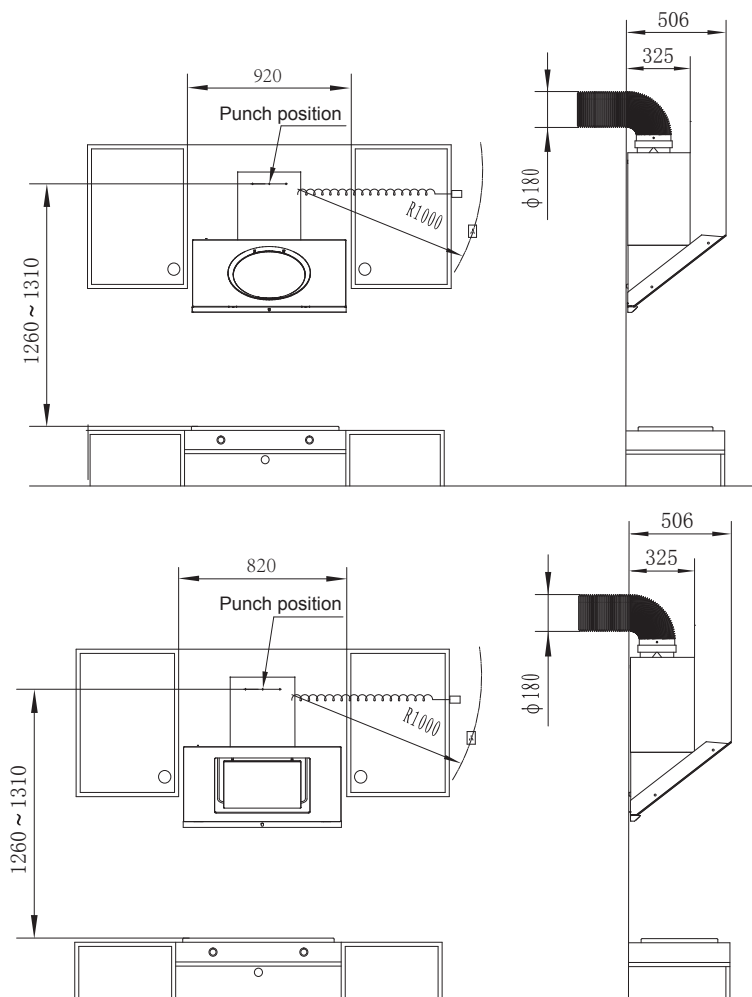

Installation sequence

This product must be installed by our company's professional staff.

1. Slide the upper cover plate in the direction of arrow, remove the buckle piece and remove the upper cover plate.
2. The internal bladder is assembled on the two side of the machine box with four M4 * 8 cross slot large flat head self tapping screws to fix the inner liner, and the back is fixed with three M4 * 8 cross slot large flat head self tapping screw.
3. It is shown that the control lead and lamp lead wire of the chassis are connected with the coil of the protection coil respectively, and are respectively connected with the connector of the switch and the lamp holder.

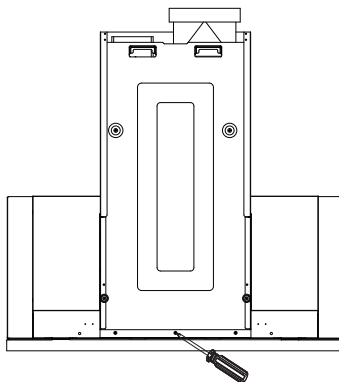
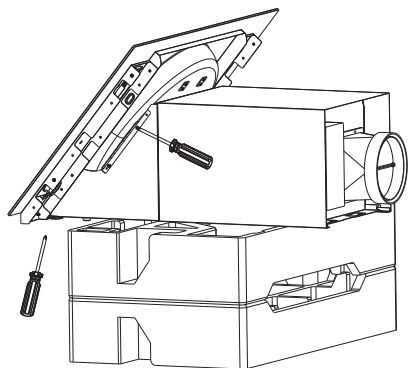
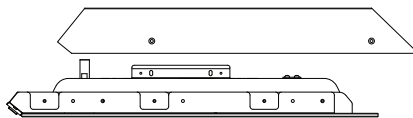
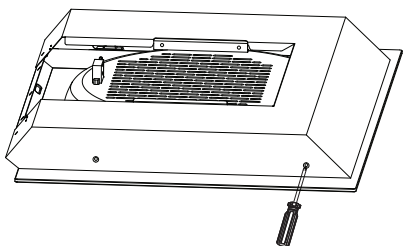

1. drill holes in the punching position of the picture, bury the plastic expansion pipe, and fix the hook bar on the wall with 3 ST5 * 45 wood screws.
2. insert the end of the exhaust pipe out of the tuyere seat, fix the exhaust pipe on the side, take the silver white tape on the exhaust pipe, and tear the bottom paper to the seams and seal it.
3. hang the main engine on the hook bar and extend the other end of the exhaust pipe outside. Or access the public flue interface to seal it.
4. use a screw to fix on the hook bar to prevent the fume hood from falling off accidentally.

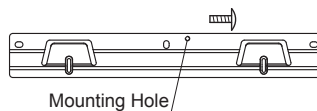
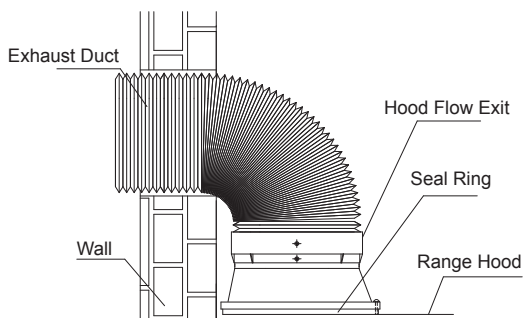

1. Determine height between cooker hob and base of hood.
2. Mark wall to suit all bracket locations. Drill holes of 50mm depth at the selected drilling position.
3. Insert the expansion tubes to fix the bracket onto the wall.
4. Install the flow exit to the hood and follow by connecting the flexible exhaust duct to the flow exit.
5. Strengthened the connection between the flow exit and the flexible exhaust duct with screws.
6. Lift and hang the hood to the wall bracket and please ensure it sits firmly on the bracket.
7. Direct the other end of the flexible exhaust duct to the outlet or wall.
8. Fit in the safety baffle of the hood onto the wall to strengthen the position and to reduce vibration when the hood is switched on.
9. Chimney extension can be installed to the ceiling or wall.
10. Ensure the oil collection container is in place before the hood is being used. To remove it for cleaning, slide the oil collection container from front to rear, vice versa for inserting it into position.

Safety Precaution

- o Ensure there is proper ventilation in the cooking area.
- o Do not perform Flambé under the hood.
- o Avoid using materials which could cause spurts of flame near the hood.
- o Do not modify the hood. Dismantle and repair can only be done by certified electrician or our authorised contractor.

Safety Instructions

1. Ensure there is proper ventilation in the cooking area.
2. Instructions concerning the discharge of air have to be followed.
3. Do not flambe under the range hood.
4. Avoid using materials which could cause spurts of flame near the range hood.
5. Never touch the lamp when it is on.
6. Do not dismantle, repair or modify the range hood on your own.

Operating Instructions

After plugging the power plug into the power supply, the hood sends out a "bite" to indicate that the power is connected. Please use the following methods for the first time. If there is any discrepancy, please contact the local distributor or service department as soon as possible.

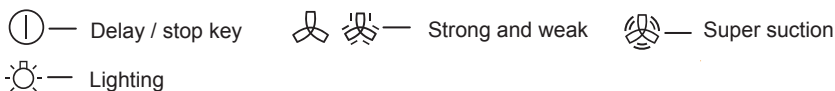

1. Delay / stop key: in the state of shutdown, press the "delay / stop key" key to activate the other function key once, and the key indicator becomes light from the extinguishing state, and then the light is extinguished by a time delay / stop key.
2. "super suction" key: press the "super suction" button, automatically switch to "strong gear" after three minutes. If you need to restart the fan, press the "super suction" button again.
3. "Strong and weak" key: press the "strong gear" button, weak exhaust "weak gear", please press the "strong gear" button, and press the key motor once again to stop working.
4. "Lighting" key: press the "lighting" button and press the "lighting" button to turn off the lighting.

Detachable Parts

1.Oil cup installation: push the oil cup into the lower foot of the hood of the hood.

Dismantle: gently pull the oil cup along the horizontal direction, then it can be unloaded. Remove as far as possible during the use of hood, and prevent excessive force when disassembling, so as not to spill oil spills or cause accidents.

2.Press the protective cover from both sides to the middle, lift up and remove the protective cover.

3. Case cover: screw the six screws of the fixed chassis cover with a cross screwdriver and lift it up.

4. Wind leaf

after unloading the chassis cover plate, screw the screw into the wind ring with the cross screwdriver and remove the intake ring.

Clockwise unscrewing the blade cap and taking out the wind blade.

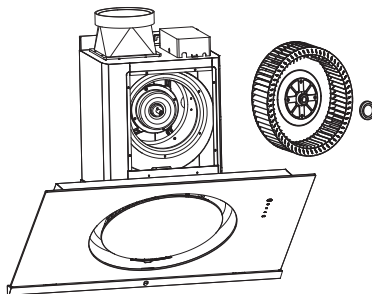
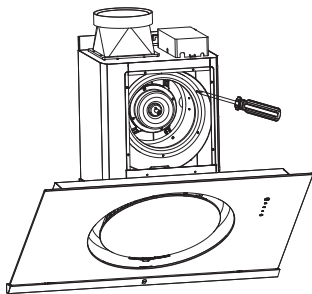
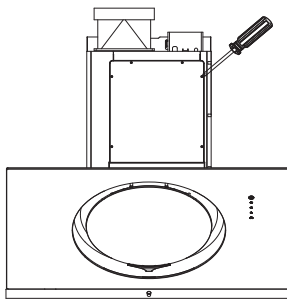
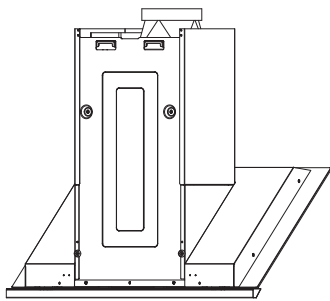

Troubleshooting

PROBLEM	POSSIBLE CAUSES	SOLUTION
Motor and light do not operate	Power plug is not inserted completely	Check the plug and insert it properly
	The light bulbs are blown	Change the bulbs
	The wire and / or cable is disconnected	Contact us for product servicing
	The light's transformer is damaged	Contact us for product servicing
Motor cannot operate but the lights are working	The impeller is stopped	Contact us for product servicing
	The capacitor is disconnected and / or damaged	Contact us for product servicing
	The motor is damaged	Contact us for product servicing
The range hood vibrates or shakes while in operation	The range hood is not installed levelly or the wall which it is installed upon is not solid	Install the range hood to a solid and steady wall
	The motor is not properly installed	Fasten the motor tightly to the body
	The damaged impeller is affecting the levelness of the range hood	Contact us for product servicing
Only one or two buttons can function while others are not working	The control panel is not functioning properly	Contact us for product servicing
	Connection with the control board is loose	Reconnect loose wires to the control board
Weak / Low Suction Power	The range hood is installed too high from the cooking hob	Lower the installation of the range hood
	There are blockages in the exhaust duct.	Remove the dirt / blockages inside the duct
	Air convection is too strong around the appliance	Do not open too many windows during cooking to improve the quality of the suction power
Oil Leakage	The range hood is not installed levelly	Install the range hood levelly